

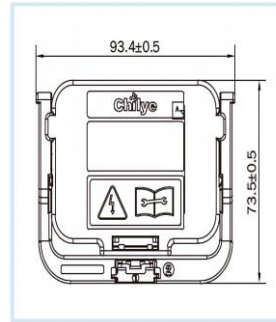

Model No. : CL-MiniMSD-PXXX, CL-MiniMSD-S, CL-MiniMSD-SF

Product Name : Mini MSD



CL-MiniMSD-PXXX

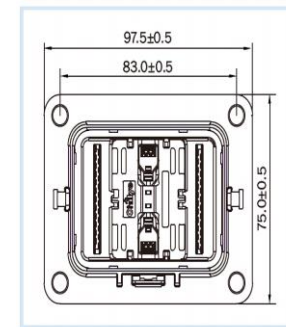
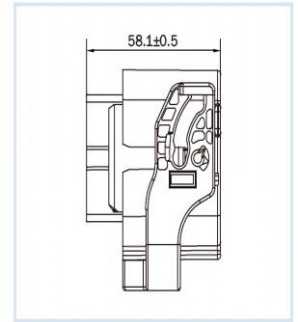

CL-MiniMSD-SF

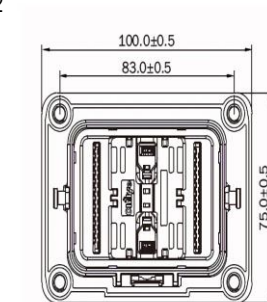
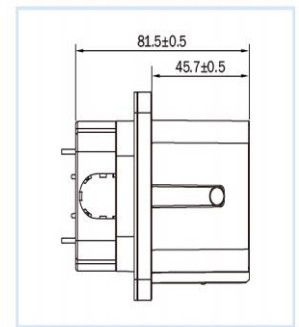

CL-MiniMSD-S

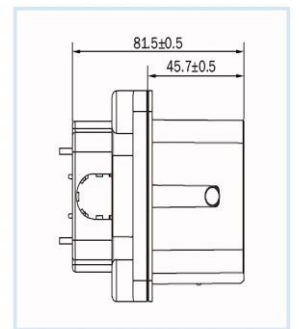

Application :

- Power battery pack

Description :

- Flange sealing, can be assembled at the front or at the rear
- Two stage unlocking design
- Fuse with different level current available
- Finger touching safe
- Light weight, compact size
- Two alternative HVIL circuit available
- Cable range: Power circuit: 25mm² to 50mm², HVIL circuit: 0.5mm²

Performance :

- Max voltage : 700V
- Max current : 400A
- Temperature range : -40°C to +125°C
- Plugging Cycle : More than 500 times
- Screw : M6
- Sealing protection : IP67, IP6K9K
- Electrical protection : IP2XB

Part Number Information

Error proof keys	Fuse Current	Plug	Head assembly	Rear assembly
1	Short connector	CL-MiniMSD-P000	CL-MiniMSD-SF	CL-MSD700-S
2	080	CL-MiniMSD-P080		
3	100	CL-MiniMSD-P100		
4	125	CL-MiniMSD-P125		
5	160	CL-MiniMSD-P160		
6	200	CL-MiniMSD-P200		
7	250	CL-MiniMSD-P250		
8	315	CL-MiniMSD-P315		
9	350	CL-MiniMSD-P350		
10	400	CL-MiniMSD-P400		